

BAGLEY AVENUE CLOSURE

RAIL CROSSING INSTALLATION

LOCAL ACCESS DETOUR ROUTE

8:00 a.m. Saturday, May 31, 2014 to
9:00 p.m. Tuesday, June 3, 2014

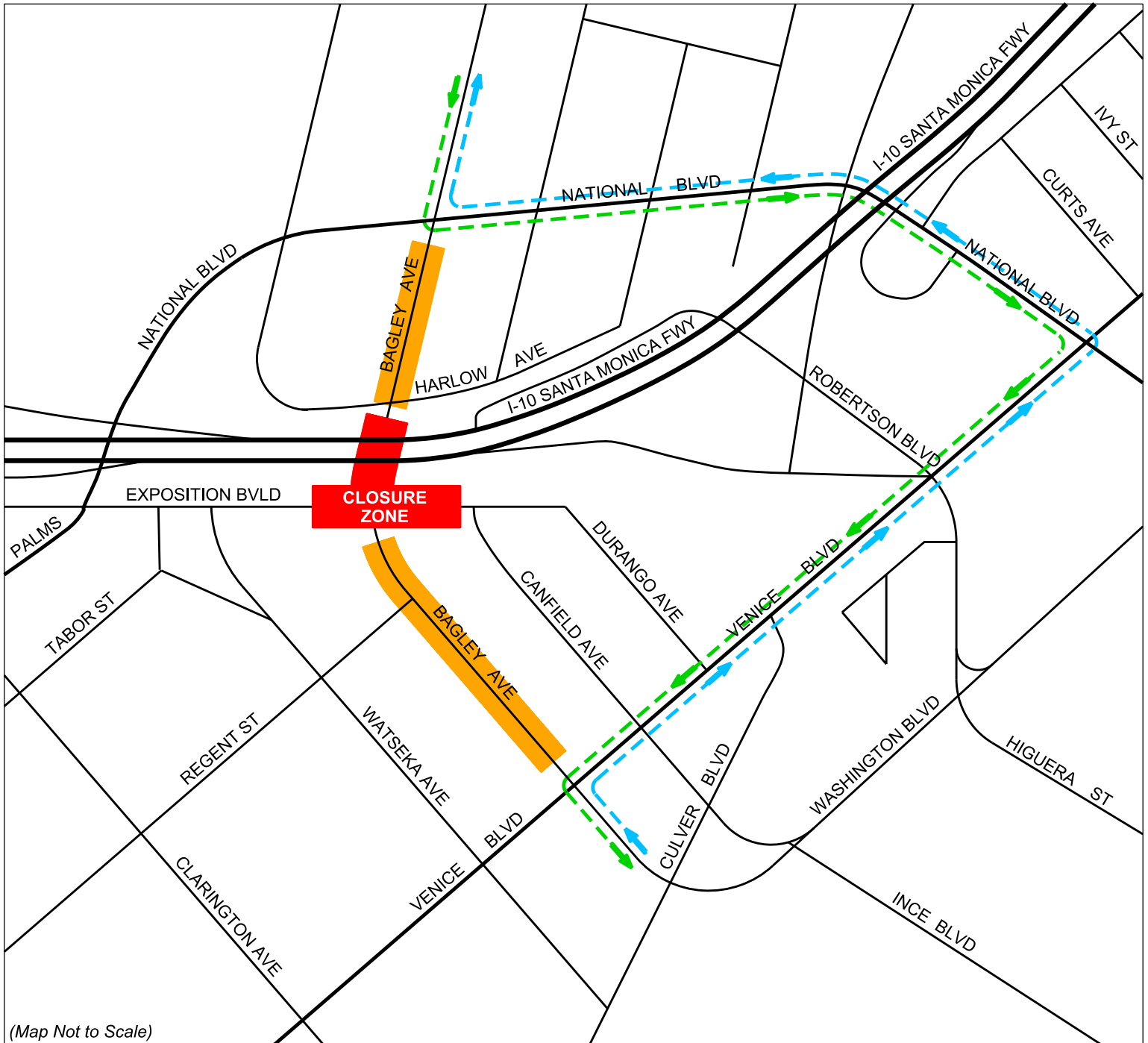

→ Southbound Bagley Ave. traffic will be detoured at National Blvd.

→ Northbound Bagley Ave. traffic will be detoured at Venice Blvd.

Local access only. No thru traffic across closure zone.

* Eastbound and Westbound National Blvd. will remain open.